

## 5C & 16C Collet Chuck Collet Options



### 5C Collets – Type 0123 16C Collets – Type G119

- Round, Hexagon or Square types available
- Smooth gripping surface only
- 0.5mm sizes available upon request

#### Dimensions (Metric)

Part No.	A	B	C	D
5C	31.75	83.40	37.30	10°
16C	48	110.50	57.50	10°

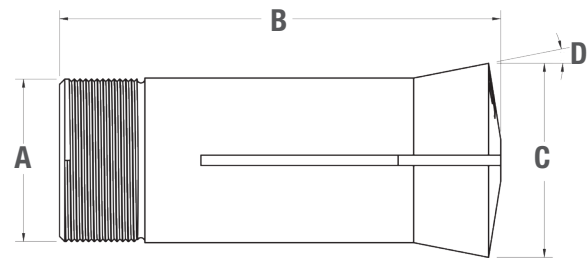

Gripping Diameter	5C - Type 0123 for DEL 5C			16C - Type G119 for DEL 16C		
	Round	Hexagon	Square	Round	Hexagon	Square
1mm	5C-R01	-	-	-	-	-
2mm	5C-R02	-	-	16C-R02	-	-
3mm	5C-R03	-	-	16C-R03	-	-
4mm	5C-R04	-	-	16C-R04	-	-
5mm	5C-R05	5C-X05	5C-S05	16C-R05	16C-X05	16C-S05
6mm	5C-R06	-	5C-S06	16C-R06	-	16C-S06
7mm	5C-R07	5C-X07	5C-S07	16C-R07	16C-X07	16C-S07
8mm	5C-R08	5C-X08	5C-S08	16C-R08	16C-X08	16C-S08
9mm	5C-R09	-	-	16C-R09	-	-
10mm	5C-R10	5C-X10	5C-S10	16C-R10	16C-X10	16C-S10
11mm	5C-R11	-	-	16C-R11	16C-X11	-
12mm	5C-R12	5C-X12	5C-S12	16C-R12	16C-X12	16C-S12
13mm	5C-R13	-	-	16C-R13	16C-X13	-
14mm	5C-R14	5C-X14	5C-S14	16C-R14	16C-X14	16C-S14
15mm	5C-R15	-	-	16C-R15	16C-X15	16C-S15
16mm	5C-R16	5C-X16	5C-S16	16C-R16	16C-X16	16C-S16
17mm	5C-R17	-	-	16C-R17	16C-X17	-
18mm	5C-R18	5C-X18	5C-S18	16C-R18	16C-X18	16C-S18
19mm	5C-R19	-	-	16C-R19	16C-X19	-
20mm	5C-R20	5C-X20	-	16C-R20	16C-X20	16C-S20
21mm	5C-R21	-	-	16C-R21	-	-

Gripping Diameter	5C - Type 0123 for DEL 5C			16C - Type G119 for DEL 16C		
	Round	Hexagon	Square	Round	Hexagon	Square
22mm	5C-R22	5C-X22	-	16C-R22	16C-X22	16C-S22
23mm	5C-R23	-	-	16C-R23	-	-
24mm	5C-R24	-	-	16C-R24	16C-X24	-
25mm	5C-R25	-	-	16C-R25	16C-X25	16C-S25
26mm	5C-R26	-	-	16C-R26	16C-X26	-
27mm	5C-R27	-	-	16C-R27	16C-X27	-
28mm	-	-	-	16C-R28	-	-
29mm	-	-	-	16C-R29	-	-
30mm	-	-	-	16C-R30	16C-X30	-
31mm	-	-	-	16C-R31	-	-
32mm	-	-	-	16C-R32	16C-X32	-
33mm	-	-	-	16C-R33	-	-
34mm	-	-	-	16C-R34	-	-
35mm	-	-	-	16C-R35	16C-X35	-
36mm	-	-	-	16C-R36	-	-
37mm	-	-	-	16C-R37	-	-
38mm	-	-	-	16C-R38	-	-
39mm	-	-	-	16C-R39	-	-
40mm	-	-	-	16C-R40	-	-
41mm	-	-	-	16C-R41	-	-
42mm	-	-	-	16C-R42	-	-

Emergency Collet with soft face and pilot hole 3mm diameter is available both for the 5C and 16C Type – Part No. **5C-EMERGENCY / 16C-EMERGENCY**